

# KLEENRITE DRAPERY TOOL STANDARD

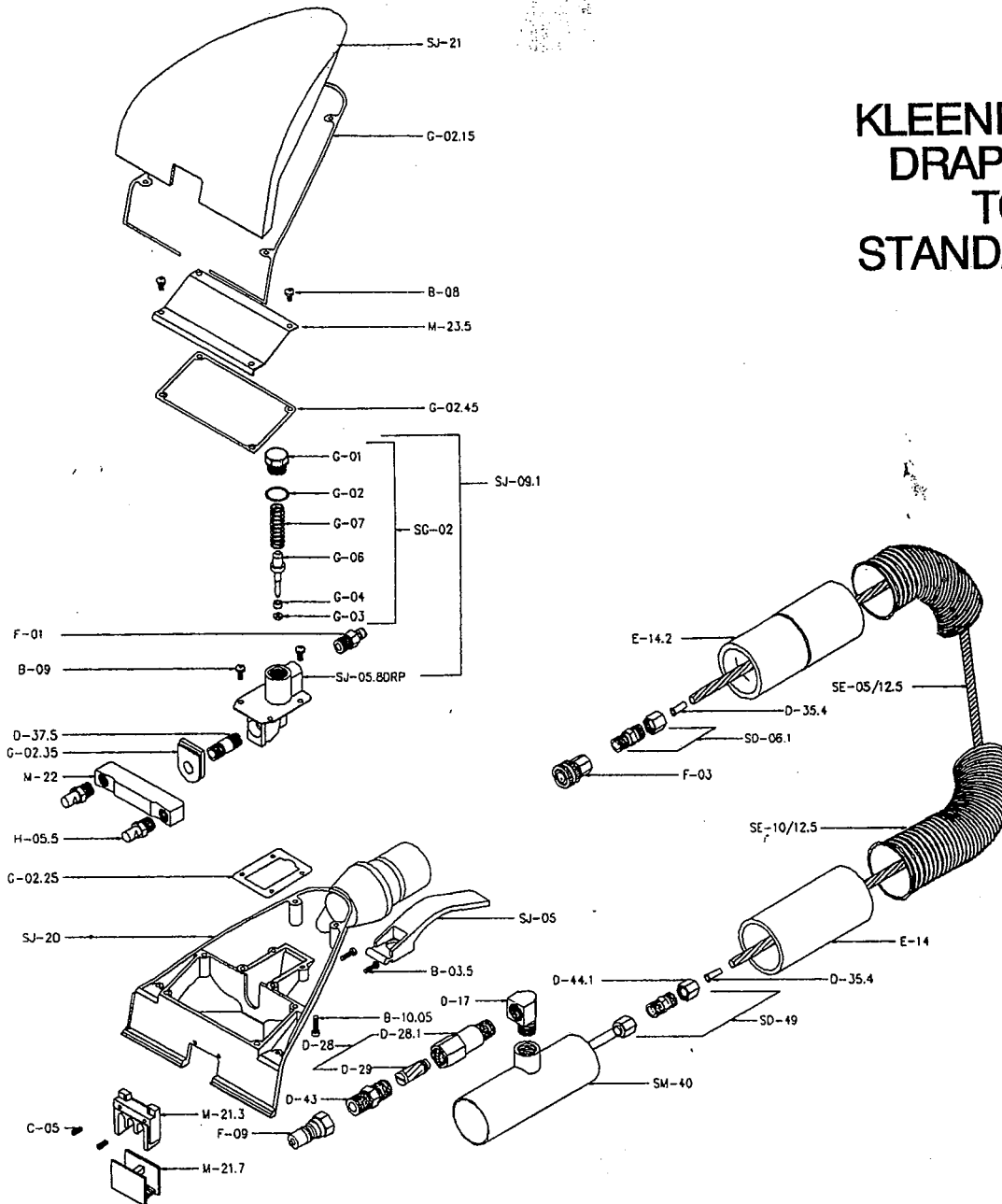

Part No.	Description	Quantity	Part No.	Description	Quantity
B-03.5	4-40 X 7/16 PHXSS	2	G-02.45	GASKET, MANIFOLD COVER	1
B-08	6-32 X 3/16 PHXSS	4	G-03	O-RING, VITON, TOOL VALVE	1
B-09	6-32 X 1/4 PHXSS	4	G-04	SLEEVE, BRASS, TOOL VALVE	1
B-10.05	6-32 X 1/2 PHILISTER XSS	4	G-06	STEM, VITON, TOOL VALVE	1
C-05	DETENT, BALL	2	G-07	SPRING, ST.ST. TOOL VALVE	1
D-17	90 ST ELBOW 1/4 NPT	1	H-05.5	JET, .50 FLOOD BRASS	2
D-28	FILTER INLINE 100 MESH	1	M-21.3	INSERT, PLEAT DIE CAST	1
D-28.1	FILTER BODY	1	M-21.7	INSERT, STANDARD DIE CAST	1
D-29	FILTER SCREEN 100 MESH	1	M-22	MANIFOLD, DRAPERY SPRAY	1
D-35.4	INSERT 1/4" NAYLON TUBE	2	M-23.5	PLATE, MANIFOLD COVER	1
D-37.5	NIPPLE, 1/8 X 1 NPT	1	SD-06.1	1/4 COMP FIT BORED TEFLON	1
D-43	NIPPLE, 1/4 HEX BRASS	1	SD-49	1/4 COMP UNION BORE/TEFLN	1
D-44.1	NUT, 1/4" INTERLOCK	1	SE-05/12.5	TUBE, 1/4" NYLON 12.5"NAT	1
E-14	CUFF, VAC 1 1/4 X 1 1/2	2	SE-10/12.5	HOSE, VAC 1 1/4 GRAY 12.5	1
F-01	Q/C 1/8" PLUG BR ST TH	1	SG-02	STEM ASM VITON TOOL VALVE	1
F-03	Q/C 1/8 SOC BR ST TH	1	SJ-05	TRIGGER, CHROMED-COMLETE	1
F-09	Q/C 1/4" PLUG BR SHUT OFF	1	SJ-05.8DRP	VALVE, DRAPERY MACH. DRP	1
G-01	CAP, BRASS, TOOL VALVE	1	SJ-09.1	VALVE, DRAPERY VIT COMP.	1
G-02	GASKET, COPPER TOOL VALVE	1	SJ-20	NOZZLE, DRAPERY W/SWIVEL	1
G-02.15	GASKET, LD DRAPERY TOOL	1	SJ-21	LD, DRAPERY	1
G-02.25	GASKET, DRAPERY VALVE	1	SM-40	VP, STANDARD (POLISHED)	1
G-02.35	GASKET, SPRAY CHAMBER	1			